

Icon Valves & Engineering Pvt. Ltd.

www.flushbottomvalve.net; fbv@ivevalves.com

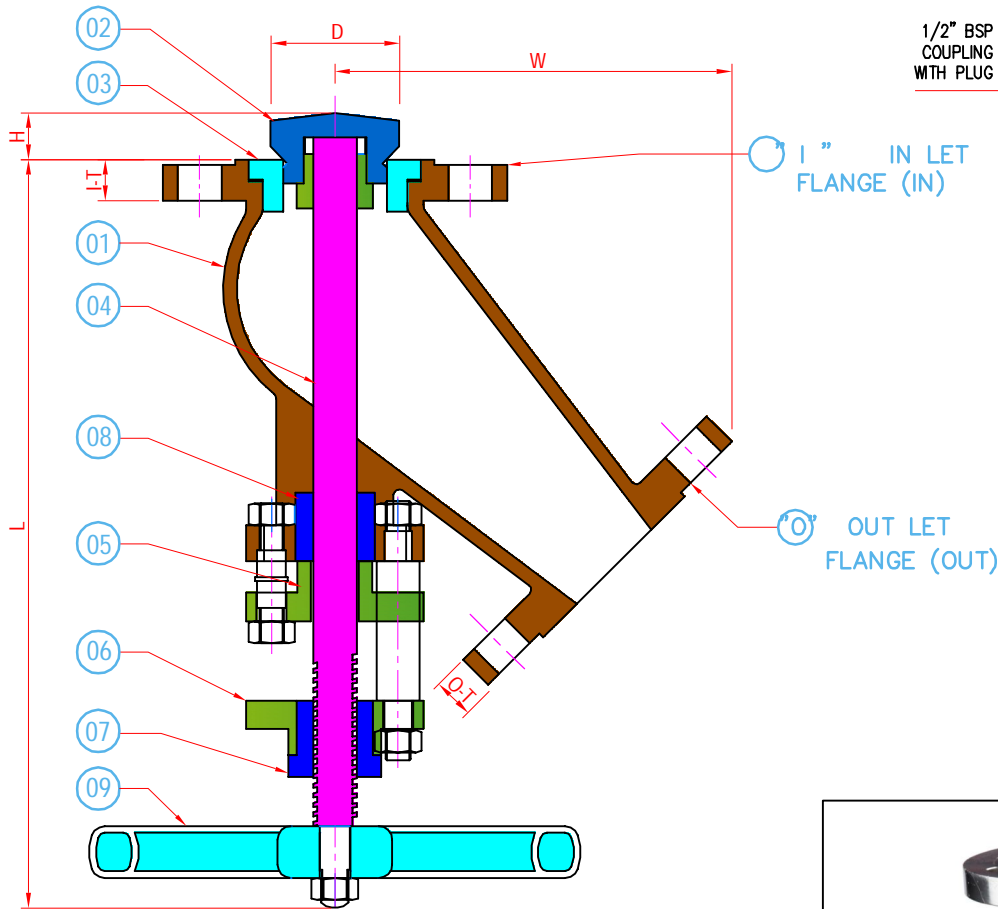

FLUSH TANK BOTTOM VALVE FLANGE ENDS DISC OPENING INTO THE TANK-SHORT HUB 150#



1/2" BSP
COUPLING
WITH PLUG

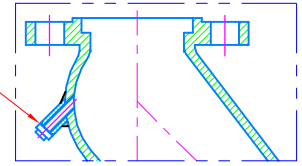

PROVISION FOR CLEANING NOZZLE

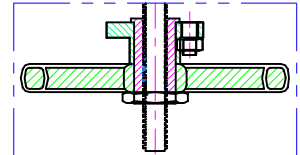

OPTION FOR RISING STEM

OUT LET
FLANGE (OUT)



FLUSH TANK BOTTOM VALVE FLANGE END DISC OPENING INTO THE TANK										
SIZE (mm)	Approx.				Approx.	(FLANGE DIMENSIONS)		(FLANGE DIMENSIONS)		APPROX. WT. / KG.
IN	OUT	L	H	D	W	I	T	O	T1	
3/4"	3/4"	275			122	AS PER 3/4" NB ASA 150#	11.0	AS PER 3/4" NB ASA 150#	11.0	06
1"	3/4"	275			122	AS PER 1" NB ASA 150#	11.0	AS PER 3/4" NB ASA 150#	11.0	07
1"	1"	300			136	AS PER 1" NB ASA 150#	11.0	AS PER 1" NB ASA 150#	11.0	08
1.1/2"	1"	300			136	AS PER 1.1/2" NB ASA 150#	14.0	AS PER 1" NB ASA 150#	11.0	09
1.1/2"	1.1/2"	340			156	AS PER 1.1/2" NB ASA 150#	14.0	AS PER 1.1/2" NB ASA 150#	14.0	10
2"	1.1/2"	355			156	AS PER 2" NB ASA 150#	16.0	AS PER 1.1/2" NB ASA 150#	14.0	11
2"	2"	385			180	AS PER 2" NB ASA 150#	16.0	AS PER 2" NB ASA 150#	16.0	12
3"	2"	400			180	AS PER 3" NB ASA 150#	19.0	AS PER 2" NB ASA 150#	16.0	14
3"	3"	425			219	AS PER 3" NB ASA 150#	19.0	AS PER 3" NB ASA 150#	19.0	21
4"	3"	440			219	AS PER 4" NB ASA 150#	24.0	AS PER 3" NB ASA 150#	19.0	24
4"	4"	500			245	AS PER 4" NB ASA 150#	24.0	AS PER 4" NB ASA 150#	24.0	33
6"	4"	525			245	AS PER 6" NB ASA 150#	25.0	AS PER 4" NB ASA 150#	24.0	39
6"	6"	700			321	AS PER 6" NB ASA 150#	25.0	AS PER 6" NB ASA 150#	25.0	65
8"	6"	700			321	AS PER 8" NB ASA 150#	28.0	AS PER 6" NB ASA 150#	25.0	75
8"	8"	920			400	AS PER 8" NB ASA 150#	28.0	AS PER 8" NB ASA 150#	28.0	90
10"	8"	900			400	AS PER 10" NB ASA 150#	30.0	AS PER 8" NB ASA 150#	28.0	110

SR NO.	DESCRIPTION	MATERIAL	QTY.
01	BODY	ASTM A216 WCB, ASTM A351 / CF8 / CF8M / CF3 / CF3M / CN7M	1
02	DISC	AISI SS 304 / SS 316 / SS 304L / SS 316L / ALLOY 20	1
03	SEAT	AISI SS 304 / SS 316 / SS 304L / SS 316L / ALLOY 20	1
04	STEM	AISI SS 304 / SS 316 / SS 304L / SS 316L / ALLOY 20	1
05	GLAND	CS / CF 8	1
06	YOKE BUSH HOUSING	CS / CF 8	1
07	YOKE BUSH	GUNMETAL	1
08	GLAND PACKING	PTFE/GF/CF PTFE WITH PTFE ROPE	1
09	HAND WHEEL	CI / SS 304	1

TECHNICAL DATA	
DESIGN & MANUFACTURING STD.	MANUFACTURERS STD. / ANSI B-16.34
TESTING & INSPECTION STD.	API 598
END CONNECTIONS :	FLANGED AS PER ANSI B-16.5 CLASS-150#.

PRIMARY SERVICE RATING & TEST PRESSURE

WORKING PRESS.	HYD. TEST PRESSURE		
	BODY	SEAT	TEMP.
150 PSIG	425 PSIG	300 PSIG	38° C
AIR TEST - SEAT		80 PSIG ±10 PSIG	